



60 min



Instrukcja montażu F8

x21 D	x21 C	x13 KD	x1 KL	x23 W - Ø3,5x16	x80 G
x12 B	x6 ZS	x3 U	x4 N	x1 P1	x1 P2
x6 W2	x21 D1	x25 R	x1 I	x8 W3 3.5x40	
mini x32 W1					

1

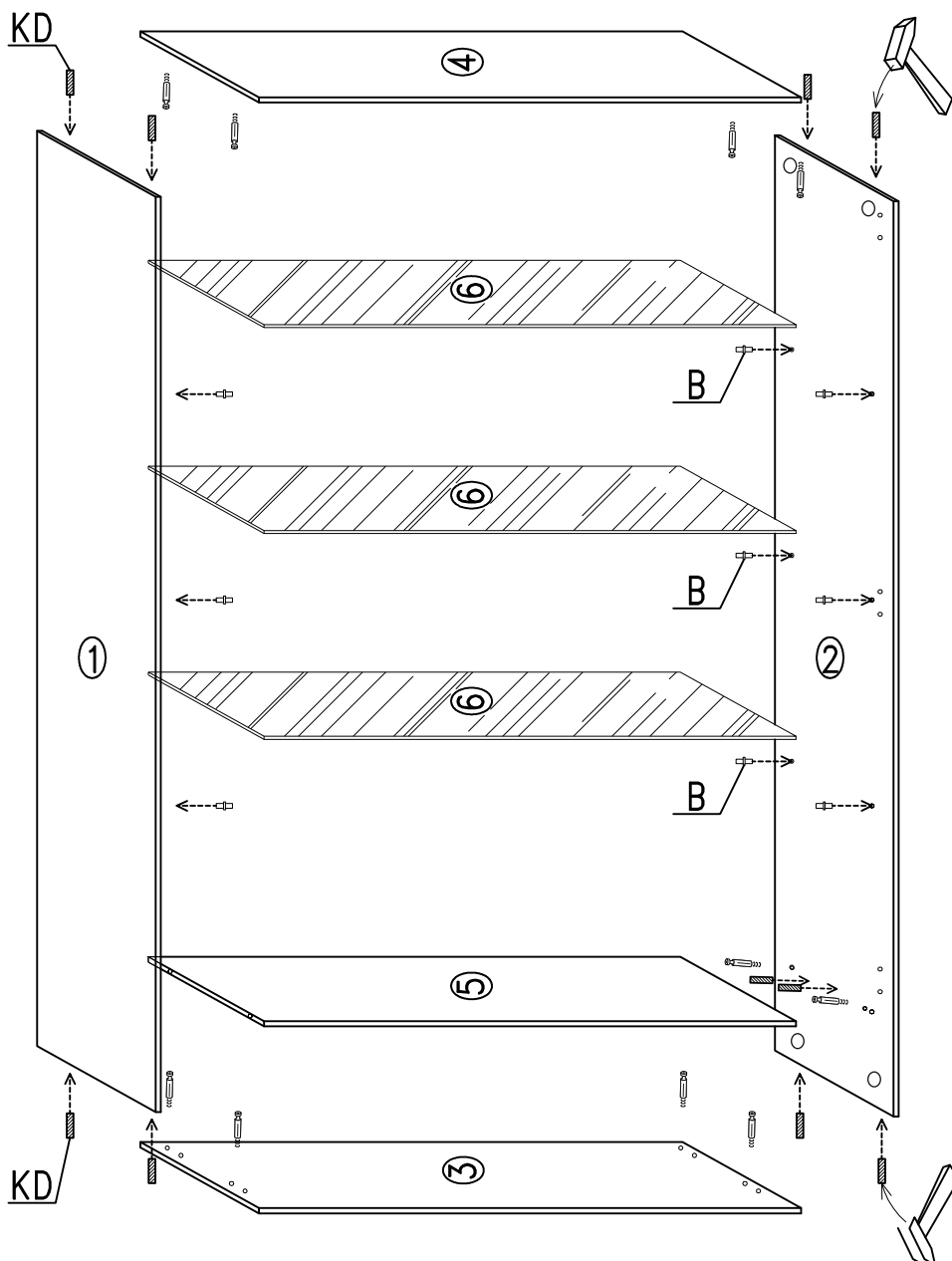

2

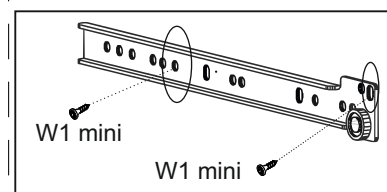
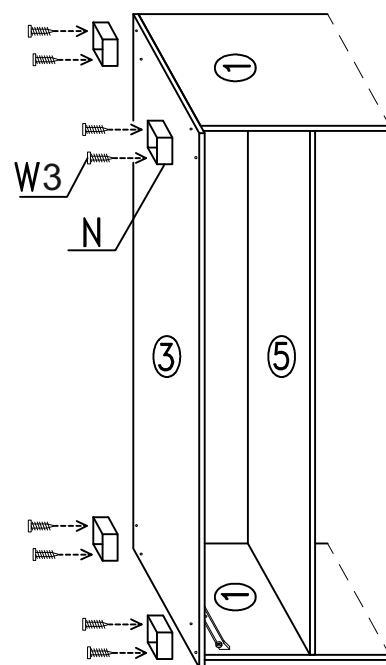

3

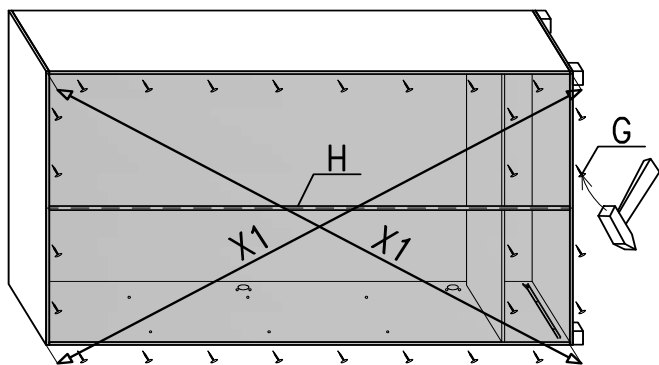

X1=X2

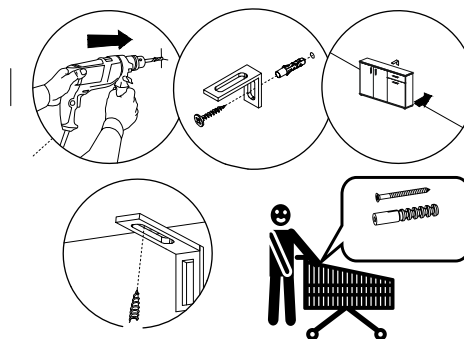

4

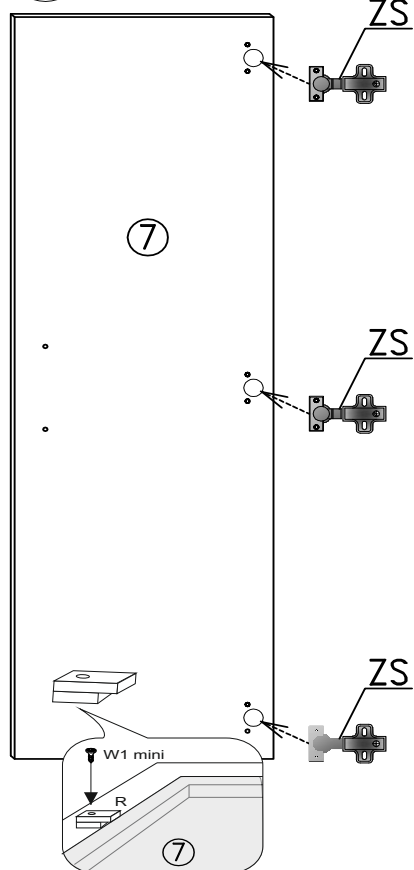

5

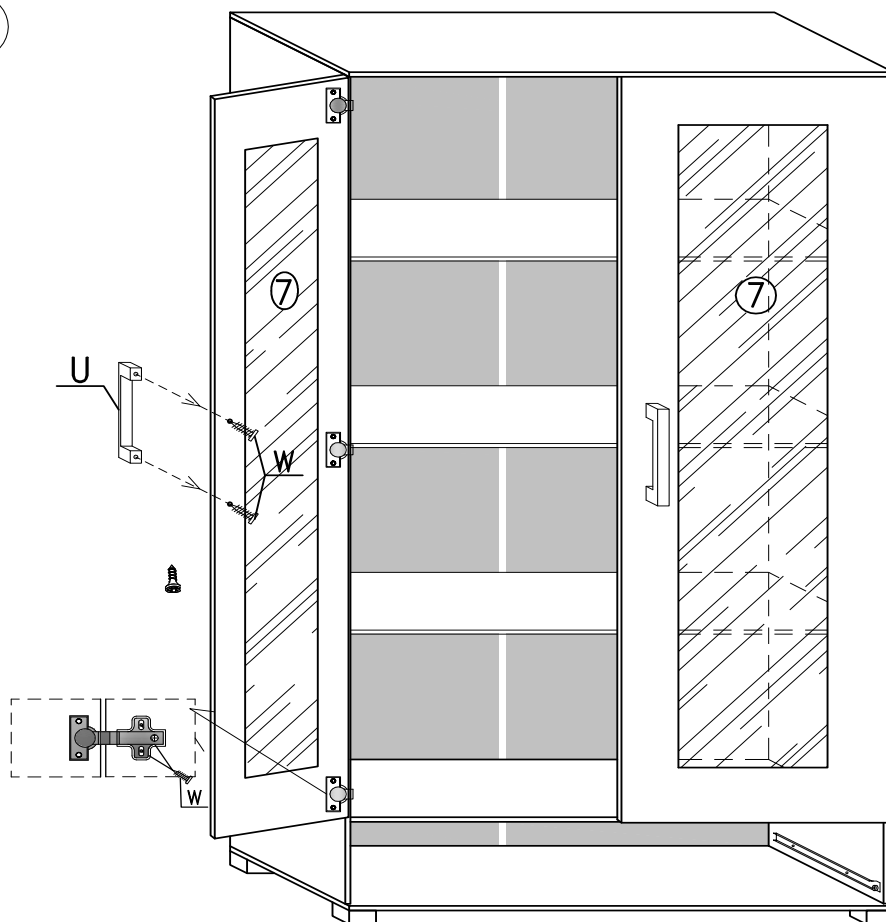

6

